



# HORTILUX®

horticulture lighting specialists™

## GRC-LED CONTROLLER

Using an EYE HORTILUX® master controller for your EYE HORTILUX® systems offers you maximum control, ease-of-use, safety, and plug-and-play installation. Just connect the controller cables to the systems with the T-splitter included with the system, plug the controller and the systems directly into the main power supply and you are set to go.



For use with EYE HORTILUX LED Grow Light Systems, sold separately

### CONTROLLER SPECIFICATIONS

<b>Input Volts</b>	100V-240V AC / 50/60Hz-5V DC
<b>Operating Temperature Range</b>	32-95°F (0-35°C)
<b>Operating Humidity</b>	< 80%
<b>Output Levels</b>	10-100%
<b>Outputs</b>	1
<b>Temperature Sensors</b>	1
<b>Maximum Drivers Connected</b>	100
<b>Weight</b>	0.55 lbs (0.25 kg)

### PRODUCT INCLUDES:

- A. Master controller
  - i. Mounting plate
- B. Manual
- C. 120-240V AC - 5V DC power adapter, 2000mA
- D. (1) Controller cables, 16ft (5m)
  - i. RJ14 (6P4C) plug (connect to driver)
  - ii. RJ9 (4P4C) plug (connect to controller)
- E. (1) Temperature sensors with cable, 16ft (5m)



*Note: For mounting, you will need to purchase (2) #6 x 1" flat-head screws.*

### DIMENSIONS

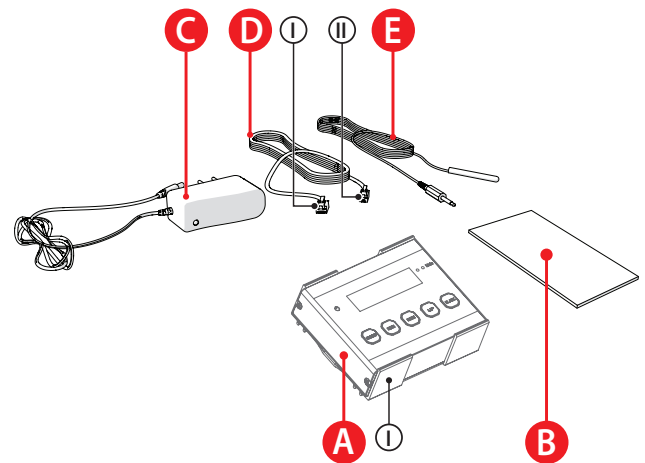
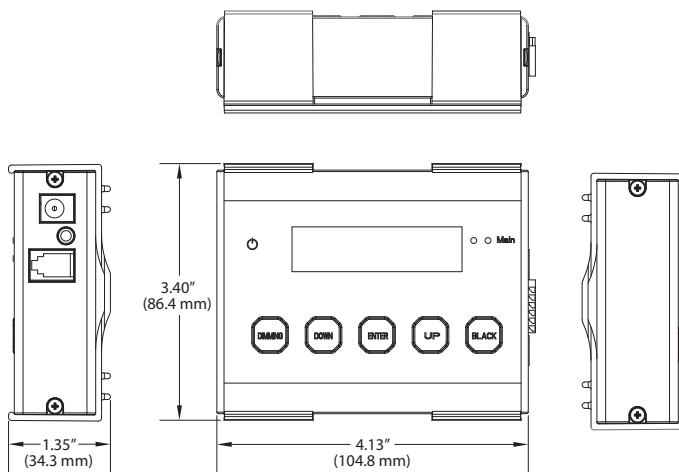

### WORKS WITH ALL EYE HORTILUX LED GROW LIGHTS\*

Ascend LED Grow Light Systems™ | Align™ LED Grow Light Systems  
(see back for details)



\* Not all models are controllable

9150 Hendricks Road Mentor, Ohio 44060  
Tel: (877) 905-2562 [www.eyehortilux.com](http://www.eyehortilux.com)

[support@eyehortilux.com](mailto:support@eyehortilux.com)

HORTILUX® is a trademark of Iwasaki Electric Co., and is registered in USA and Japan

©EYE HORTILUX® All Rights Reserved. EQS4718